

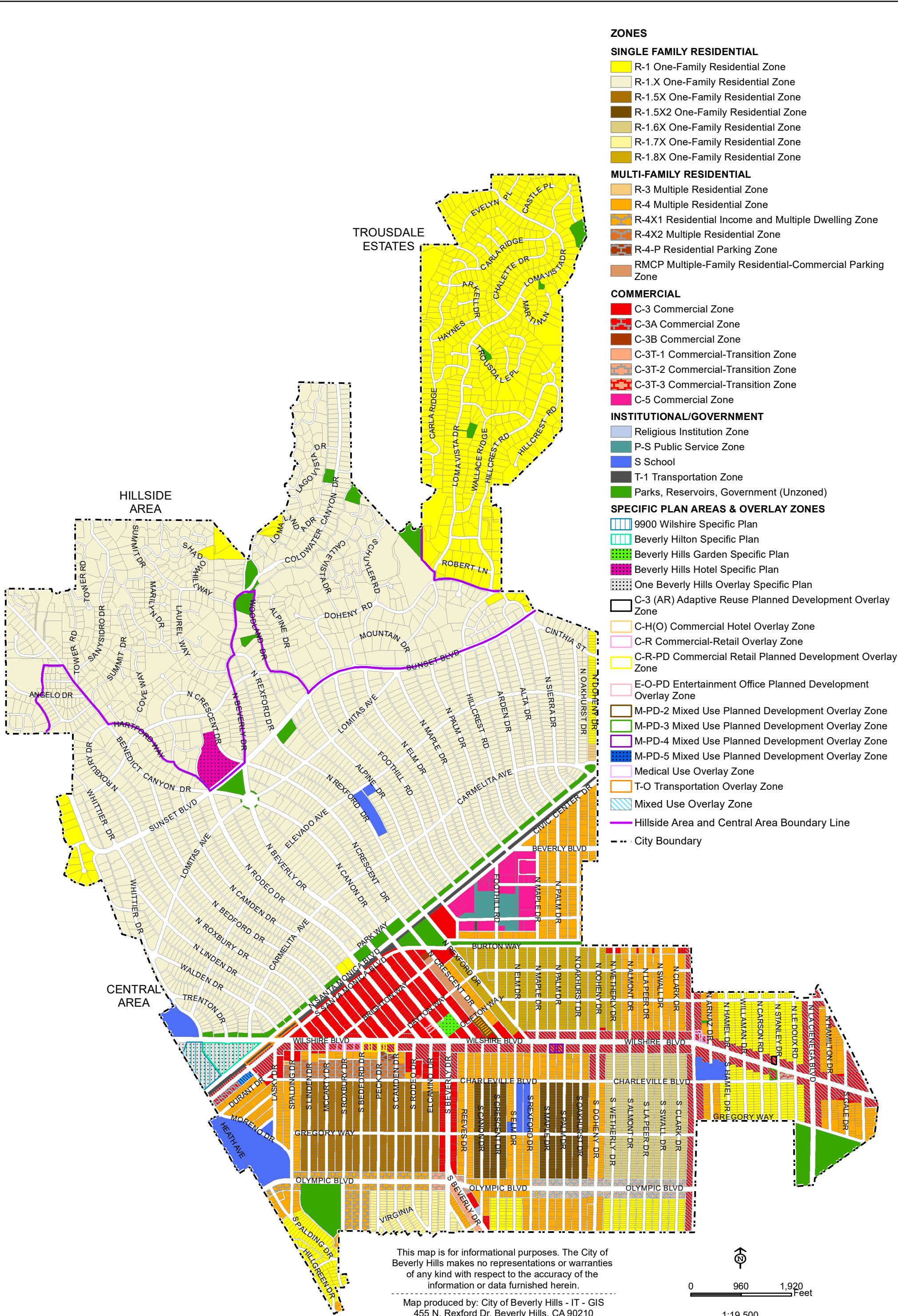

Zoning Map - City of Beverly Hills



This map is for informational purposes. The City of Beverly Hills makes no representations or warranties of any kind with respect to the accuracy of the information or data furnished herein.

Map produced by: City of Beverly Hills - IT - GIS
455 N. Rexford Dr. Beverly Hills, CA 90210
June 05, 2024

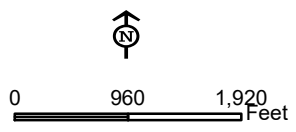

1:19,500



General Plan Land Use Designations - City of Beverly Hills

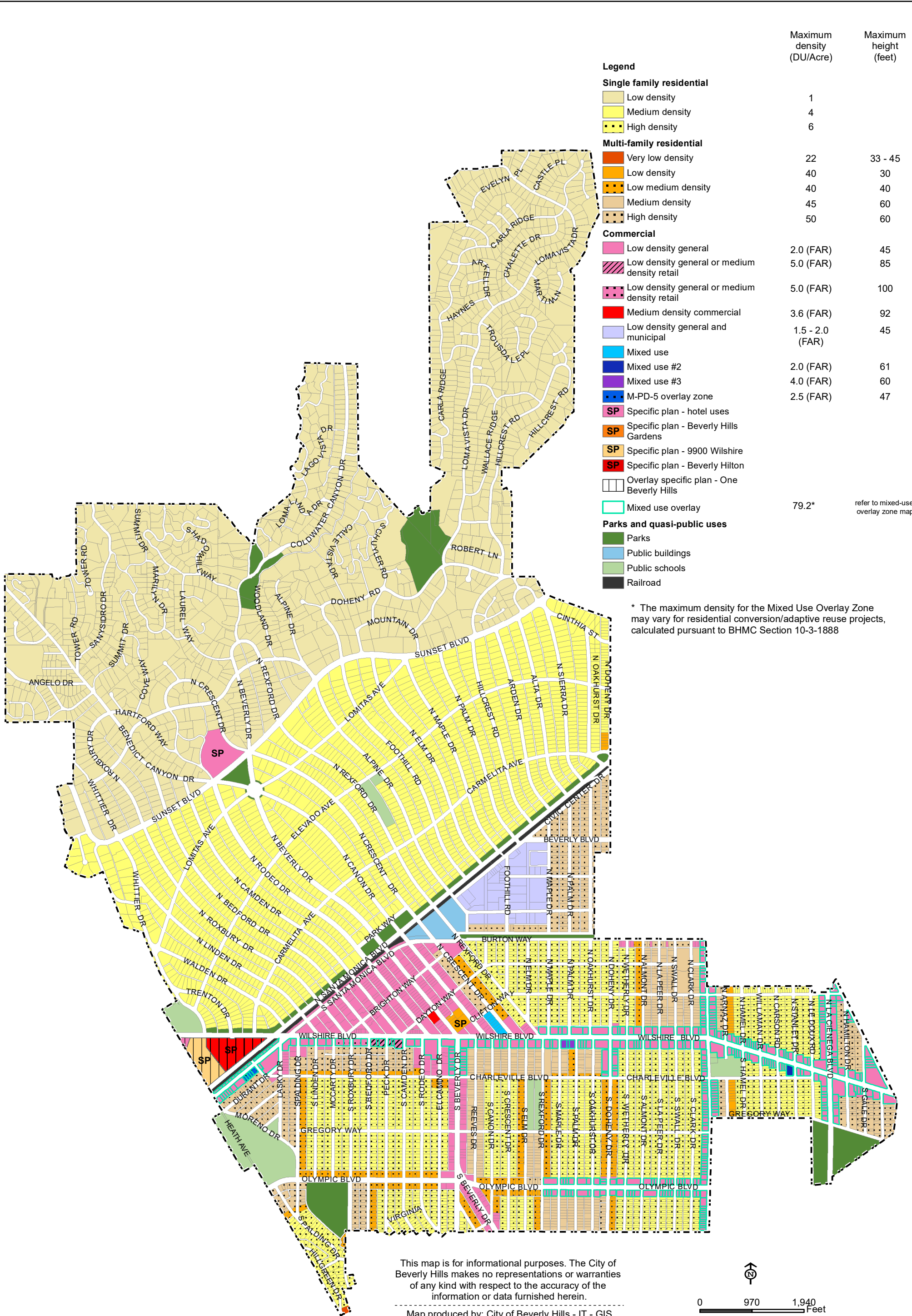

* The maximum density for the Mixed Use Overlay Zone may vary for residential conversion/adaptive reuse projects, calculated pursuant to BHMC Section 10-3-1888

This map is for informational purposes. The City of Beverly Hills makes no representations or warranties of any kind with respect to the accuracy of the information or data furnished herein.

Map produced by: City of Beverly Hills - IT - GIS
455 N. Rexford Dr. Beverly Hills, CA 90210
June 05, 2024

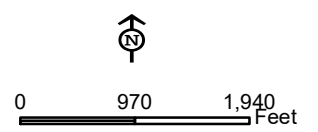

1:19,500